

PAN

ZP6211.H









Miscelatore monocomando lavabo con leva clinica. / Single lever basin mixer with sanitary lever.

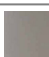
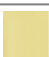
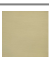

Miscelatore monocomando lavabo con leva clinica, aeratore, scarico da 1 ¼", flessibili di collegamento. Water Saving - portata d'acqua uguale o inferiore a 6 l/min.

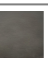
Single lever basin mixer with sanitary lever, aerator, 1 ¼" pop-up waste, flexible tails. Water Saving - water flow rate of 6 l/min or less.

Finiture / Finishes

 Cromo / Chrome	 C3 Nickel Spazzolato / Brushed Nickel	 C8 Nickel Lucido / Polished Nickel	 C40 Oro / Gold	 C41 Oro spazzolato / Brushed Gold	 C50 Metal Black / Metal Black	 C51 Metal Black spazzolato / Brushed Metal Black	 W1 Bianco Opaco Goffrato / Embossed Matt White
 N1 Nero Opaco Goffrato / Embossed Matt Black	 N6 Nero opaco / Matt black						

PAN

ZP6211.H

Disegno Complessivo / Overall Drawing

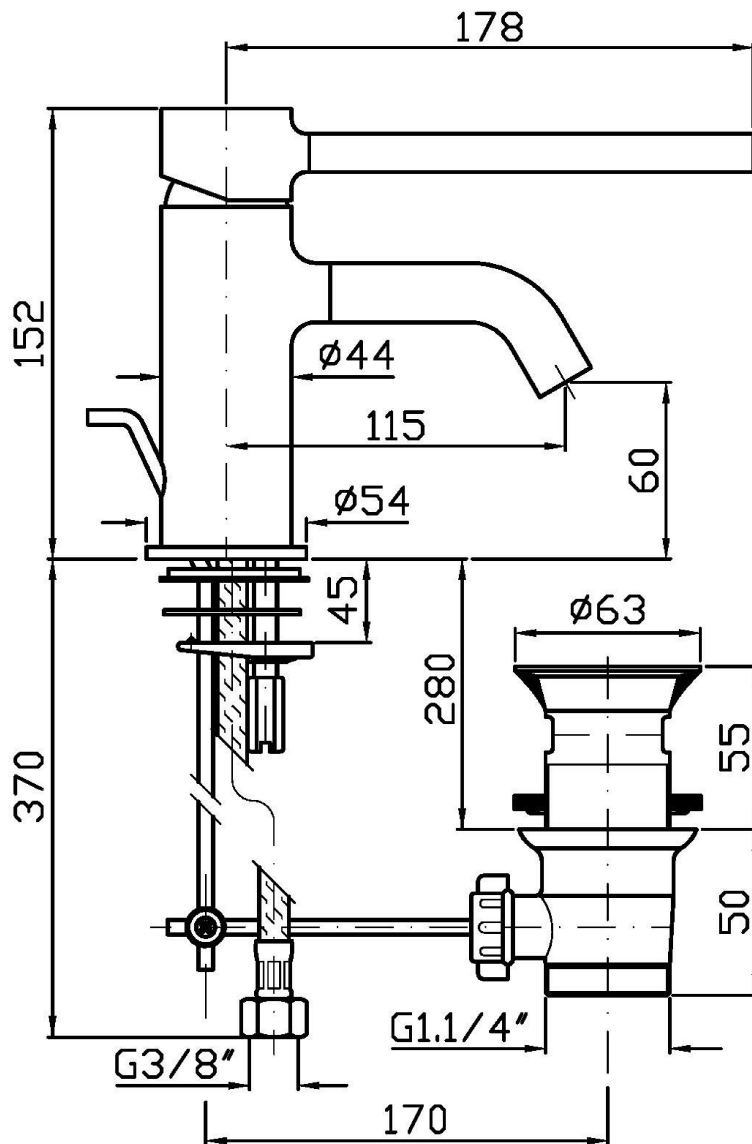

PAN

ZP6211.H

Esplosi / Exploded

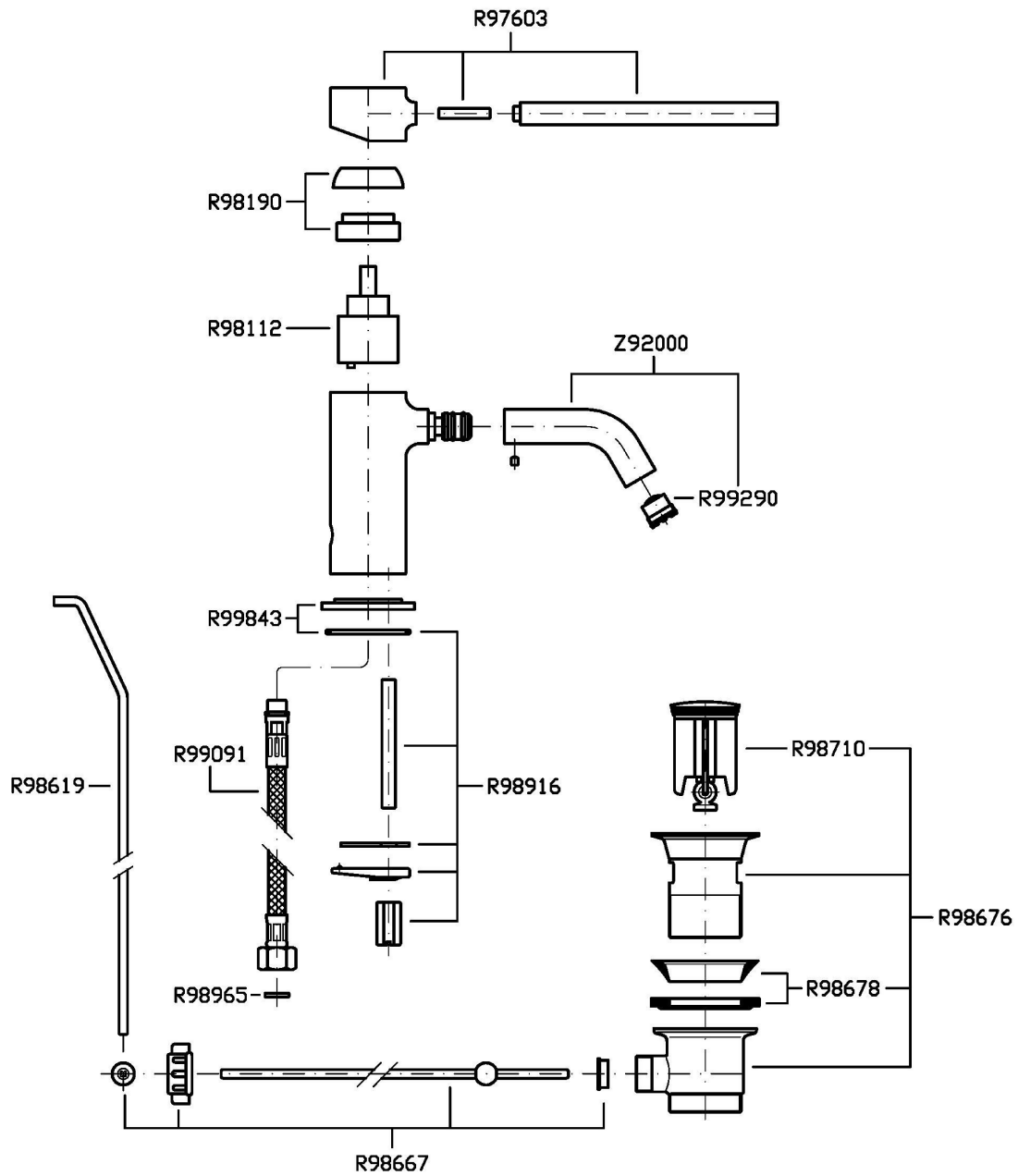

PAN

ZP6211.H Portate / Flowrates (lt/min)

PRESSIONE PRESSURE	1 BAR	2 BAR	3 BAR	4 BAR	5 BAR
P1 LAVABO BASIN	4,8	5	5	5	5
P2					
P3					
P4					
P5					

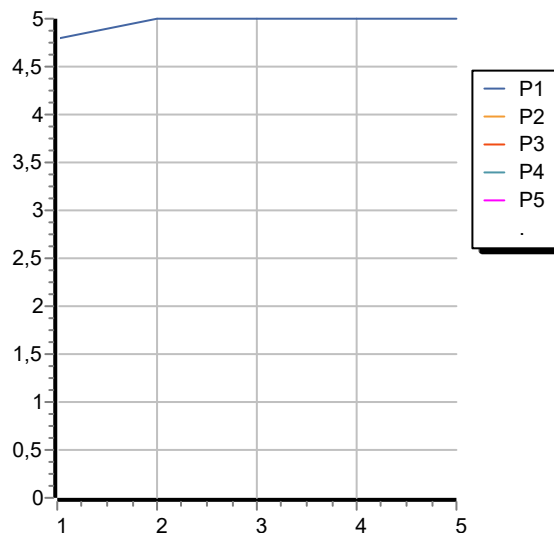

PAN

ZP6211.H Pesì e Misure / Weights and Sizes

Peso (Kg) Weight (lb)	2,40 (Kg)	5,29 (lb)
Volume test (dc3) - (in3)	7,43 (dc3)	453,41 (in3)
h (mm) - (in)	90,00 (mm)	3,54 (in)
L1 (mm) - (in)	250,00 (mm)	9,84 (in)
L2 (mm) - (in)	333,00 (mm)	13,11 (in)

